

Installation Instructions

Structural Surfaces™ Series Claddy-T™ Shelf (Tile-over Tray)

T	Complete Kit	Anchor PermaTile™ Rough-In
Tile Thickness Range 5/32" – 1/2" (4mm – 13mm)		Tile Substrates Surface Mount to Substrate

Instructions also apply to
Claddy-T™ Shelf
(sold separately)

Instructions also apply to
Glass Tile Shelving (6mm)
(sold separately)

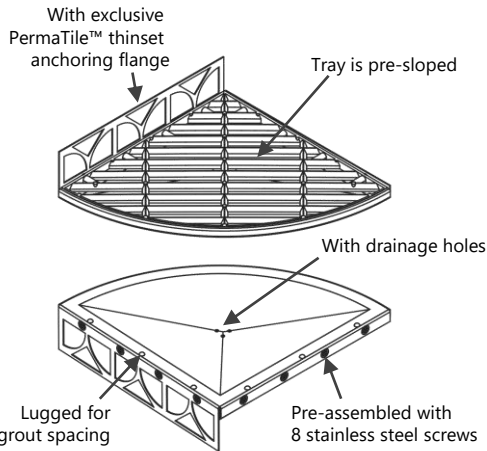

STEP 1 – Install Board

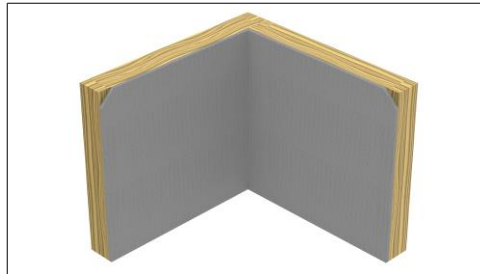

Technical Fact

PermaTile™ Rough-In Anchor will work with all tile board substrates, including cement, fiber and foam-core materials. (only use materials that meet ANSI standards for tile applications).

STEP 2 – Applying Thinset

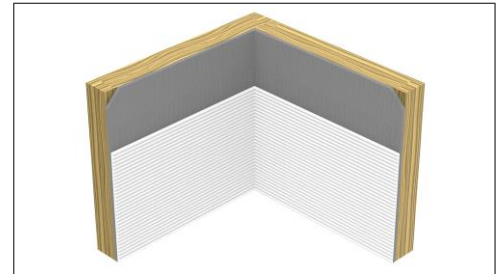

WARNING

Use only latex modified mortars that meet ANSI A118.4 or A118.15 standards. We recommend using a minimum of 1/4" x 3/8" notch trowel.

STEP 3 – Determine Rough-In & Tray Location

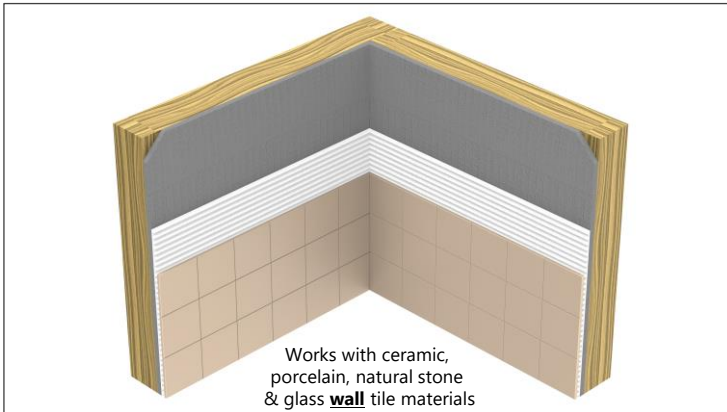

WARNING

Before installing PermaTile™ Rough-In Anchor and Claddy-T™ tray, both corner walls **MUST** be tiled at the same height. This ensures that all lugs rest on the same plane for grout spacing and that the tray is level. See **PRODUCT LIMITATION #1**

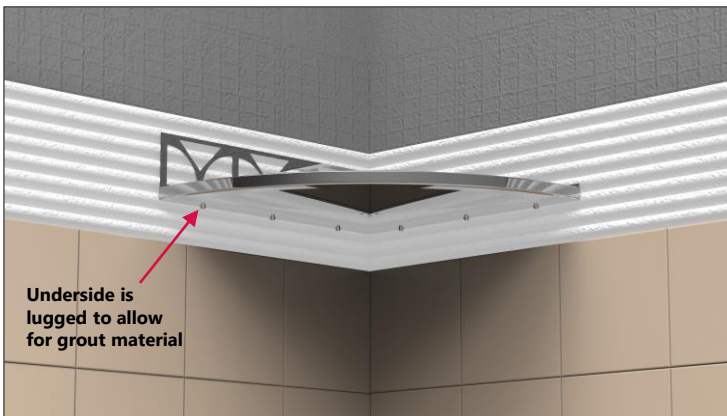

STEP 4 – Install and Fill Tray

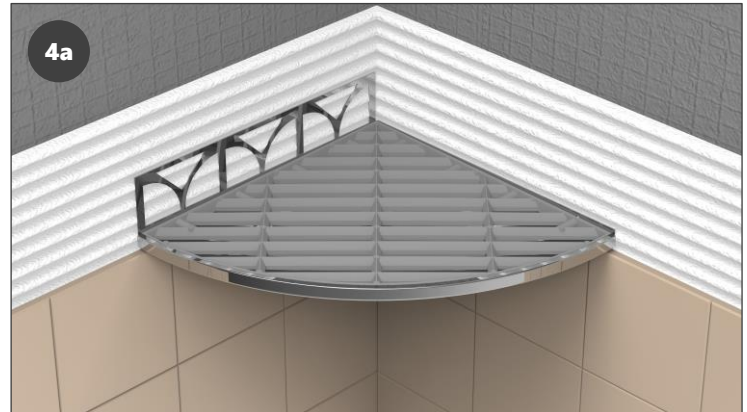

- **[See 4a]** To install tray, set lugs on top of wall stack material and press PermaTile™ Rough-In Anchor into wall substrate.
- **[See 4b]** Fill tray with **UNMODIFIED** thinset mortar **ONLY**, filling all grids cavities in tray. See **PRODUCT LIMITATION #2**
- Using the flat side of a trowel, flatten thinset so it is flush with top of grid in tray.

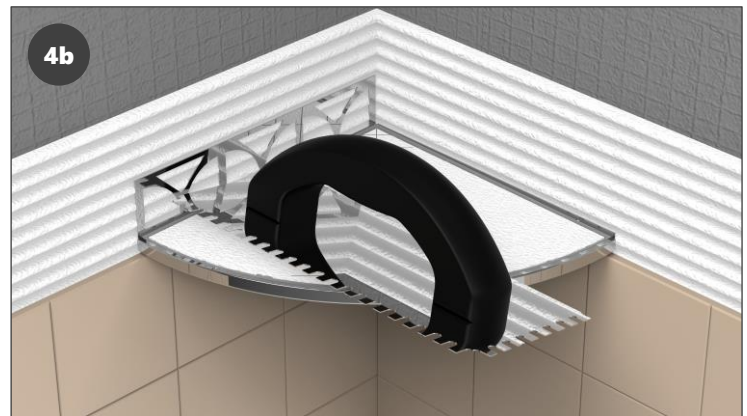

PRODUCT LIMITATION

- 1) **INTEGRATING TRAY with WALL TILE:** The patented perforated leg of the Claddy-T™ (Tile-over Tray) will work with ceramic, porcelain, natural stone and glass tile materials. System tested using ANSI A118.4 thinset mortars and ANSI A137.1 – 4-1/4" x 4-1/4", glazed wall tile. Tile materials equal to or larger than tested size will match test performance. It is recommended that tile materials smaller than tested size employ a higher bond strength thinset mortar equal to ANSI A118.11. When setting glass tiles, follow thinset manufacturer guidelines precisely.
- 2) **INTEGRATING TRAY with SHELF TILE:** Fill inside of Claddy-T™ tray with ANSI A118.1 unmodified thinset 'only'. Use also ANSI A118.1 unmodified thinset to install glass tile shelf materials 'only'. Note: **This product is not designed as a foot rest or support.**

**To Install
Glass Tile
Shelving
See Reverse Side**

Installation Instructions

Bella Vetro™ Series Glass Tile Shelving (6mm)

T

Complete Kit

Anchor

PermaTile™ Rough-In

Tile Thickness Range
5/32" – 1/2" (4mm – 13mm)

Tile Substrates
Surface Mount to Substrate

Instructions also apply to
Claddy-T™ Shelf
(sold separately)

Instructions also apply to
Glass Tile Shelving (6mm)
(sold separately)

Technical Fact

TileWare Products Bella Vetro™ Series Glass Tile Shelving is manufactured by fusing clear glass with ceramic glazes at a high temperature. Glass tile shelves may be used in interior and exterior applications, in both wet and dry locations. All shelves are 6mm (1/4") thickness. Glass tile shelving works ONLY with our Structural Surfaces™ Series Claddy-T™ Shelf (Tile-over Tray).

WARNING

This installation process is specific, addressing how to install Bella Vetro™ Glass Tile Shelving with Structural Surfaces™ Series Claddy-T™ Shelf (Tile-over Tray), pictured on reverse side. Both glass tile shelf and tray with patented flange require no modifications, cutting or drilling. Each component is pre-sized in our factory to work and assemble together with ease.

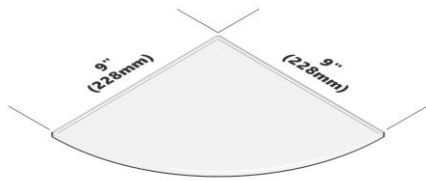

STEP 5 – Back Butter Glass Tile Shelf

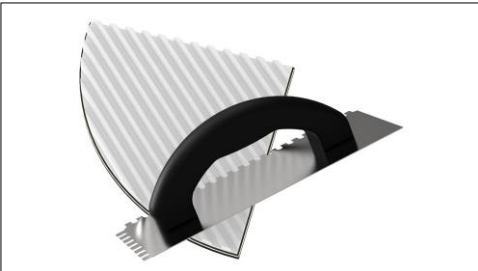

- **PLEASE NOTE:** Bella Vetro™ Glass Tile Shelves are sold separately from Claddy-T™ Shelf... read specific instructions before installing. **See PRODUCT LIMITATION #2 on reverse side.**
- Back-butter glass tile with a 1/4" x 1/4" notched trowel.

STEP 6 – Install Glass Tile Shelf onto Tray

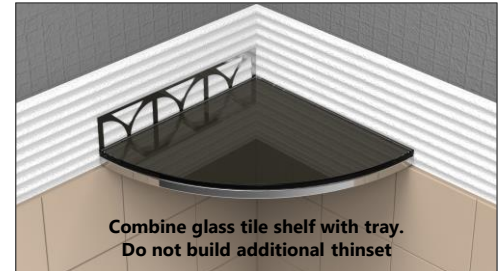
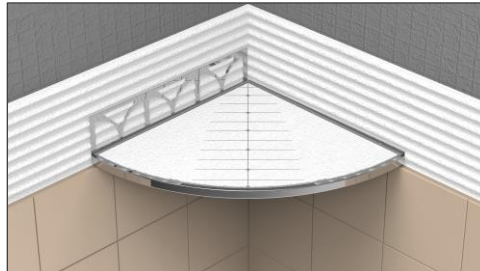

Combine glass tile shelf with tray.
Do not build additional thinset

Pro Tip

Optionally replace glass tile shelf with any custom materials. Works with ceramic, porcelain, natural stone, glass & mosaic shelf tile materials.

WARNING

Set glass tile shelf on top of tray with **UNMODIFIED** thinset mortar **ONLY**. Shelf tile must be installed before wall tile.

STEP 7 – Create Cut Line Using Level



Continue to install full tiles until cuts must be made.

Using a level, set on top of wall stack, then draw a pencil line to determine height of each cut tile following pre-slope of glass on tray.

STEP 9 – Repeat on opposite side



STEP 10 – Grout Walls & Around Tray

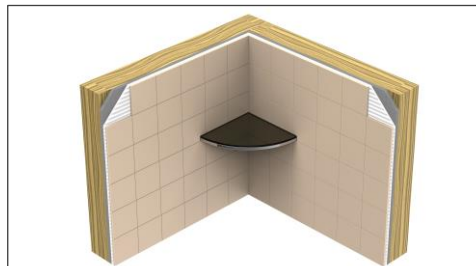

Congratulations!
Installation is now complete.
Thank you for using our products!

We would like to invite you to leave an unbiased review or feedback and share your experience with others.

Facebook: <https://www.facebook.com/TilewareProducts/>
Instagram: https://www.instagram.com/tileware_products/

PRODUCT LIMITATION

Outlined installation instructions were designed to work exclusively with TileWare Products Bella Vetro™ Glass and Claddy-T™ Tray products. Other uses for our glass tile shelves are not intended to be covered or addressed in these instructions. Use ANSI A118.1 unmodified thinset mortar 'only'. Install glass tile shelf before wall tile. Specified thinset is intended to create density in tray.

DO NOT USE MODIFIED THINSETS WITH BELLA VETRO™ GLASS BECAUSE OF SHRINKAGE. **NOTE:** THIS PRODUCT IS NOT DESIGNED AS A FOOT REST OR SUPPORT. DO NOT USE GLASS TILE INDEPENDENTLY OF TRAY AND PERMATILE™ INSTALLATION SYSTEM. DO NOT INSTALL OVER FLEXIBLE SURFACES OR UNSECURED SUBSTRATES. DO NOT EXPOSE GLASS TILES TO HIGH ABRASION, STRONG IMPACT, MECHANICAL STRESSES OR THERMAL SHOCK.

**To Install
Claddy-T™ Shelf
See Reverse Side**