

TOL	MATERIAL	PACK	YES	FINISH	YES	DESCRIPTION	PART #	C501XXX-684	DWG #	810
±	SEE BELOW	AVONITE, ACRYLIC SOLID SURFACE, 1/2" [12mm]	SEE NOTES BELOW			CURB, FINISHED TOP ONLY, 6" X 84"	SCALE	1:2	SHEET	1 OF 4

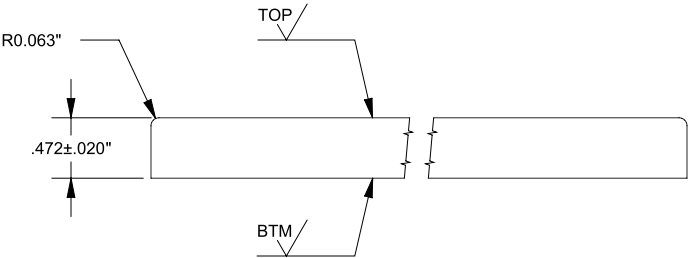
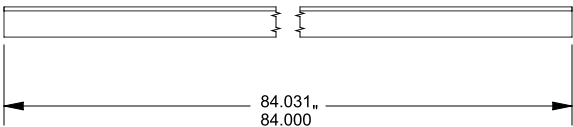
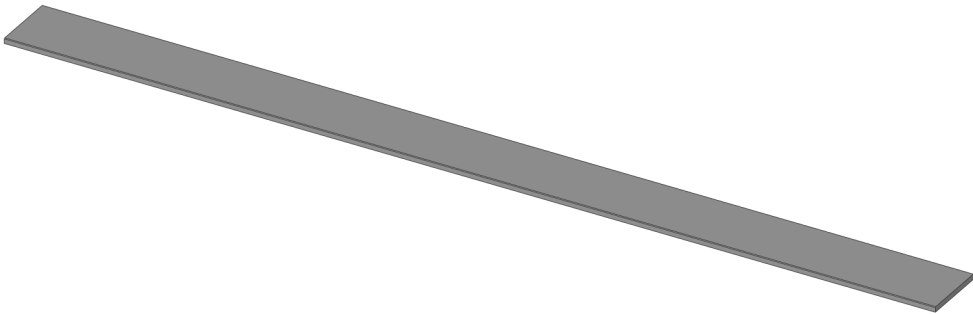
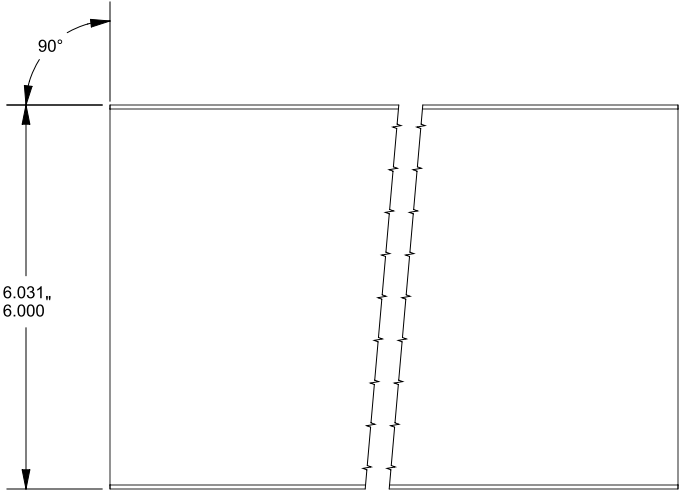

SCALE 2:3

COLORS
BONE (BON)
DOVE GREY (DVG)
IVORY (IVO)
SUPER WHITE (WHT)

TOOLING / FIXTURE	LOC	MFG. INSTRUCTION / PART INSPECTION	EC #	REVISION	BY	DATE	TW-ENG1	
		NOTES - 810 UNITS PER LB = 0.068, 867 UNITS PER LB = 0.135	1	ADDED 810+867-LAYOUT	RLS	4/26/23	APPROVALS	DATE
		BASED ON SHEET SIZE, THICKNESS = 1/2" [12mm], DIMENSIONS = 30" X 144" [762mm X 3658mm]	2	MADE 810+867-LAYOUT	RLS	4/26/23	DRAWN BY: RLS	1/27/22
		DO NOT TRIM SHEET, DROP TO BE USED TO MACHINE 867		PRIMARY CNC LAYOUT			APPROVED: DHS	4/26/23
		SURFACE FINISHING = 1 SIDED, TOP ONLY	3	ADDED RETAIL PACKAGING	RLS	4/26/23	SHOP:	
		SEE SHEET 4 - COMPONENTS PER FULL SHEET - 810 + 867 = 4X / 4X	4	ADDED BONE (BON)	RLS	4/26/23	REVISION: DHS	4/26/23
		PACKAGING, BULK PACKED ON PALLET (TOP TO TOP, BTM TO BTM)	5	ADDED IVORY (IVO)	RLS	4/26/23	TileWare Products engineering@tilewareproducts.com 1021-16th St SW, Hickory, NC 28602 Office (828) 322-9273 Fax (828) 304-1076	
		PACKAGING FOR RETAIL SALE, PACKED AND TAPED IN SCORED PAD, PART # C910-073						
		MACHINE TO SPECIFICATIONS ABOVE						
<small>Copyright © 2012-2023 TileWare Global, LLC dba TileWare Products®. All rights reserved. PermaTile™ Fastener Patented. US Patent No. 8,161,700 Australian Patent No. 2011205360 Canadian Patent No. 2,787,033. System And Method For Wall Mounting With A Rotating Bushing Patented. US Patent No. 10,989,935</small>			WEIGHT:		14.725 / 7.423 LB	CUBED:	237.747 / 119.851 IN³	

Technical drawing of a 144x30 inch sheet layout. The sheet is divided into a 3x4 grid of 12 rectangular panels. Each panel is 6 inches high and 0.563 inches wide. The total width is 144 inches and the total height is 30 inches. A 0.5 inch margin is shown on the left side. A color legend is provided at the bottom right.

COLORS
BONE (BON)
DOVE GREY (DVG)
IVORY (IVO)
SUPER WHITE (WHT)

TOOLING / FIXTURE	LOC	MFG. INSTRUCTION / PART INSPECTION	EC #	REVISION	BY	DATE	TW-ENG1	
		NOTES - 810 UNITS PER LB = 0.068, 867 UNITS PER LB = 0.135	1	ADDED 810+867-LAYOUT	RLS	4/26/23	APPROVALS	DATE
		BASED ON SHEET SIZE, THICKNESS = 1/2" [12mm], DIMENSIONS = 30" X 144" [762mm X 3658mm]	2	MADE 810+867-LAYOUT	RLS	4/26/23	DRAWN BY: RLS	1/27/22
		DO NOT TRIM SHEET, DROP TO BE USED TO MACHINE 867		PRIMARY CNC LAYOUT			APPROVED: DHS	4/26/23
		SURFACE FINISHING = 1 SIDED, TOP ONLY	3	ADDED RETAIL PACKAGING	RLS	4/26/23	SHOP:	
		SEE SHEET 4 - COMPONENTS PER FULL SHEET - 810 + 867 = 4X / 4X	4	ADDED BONE (BON)	RLS	4/26/23	REVISION: DHS	4/26/23
		PACKAGING, BULK PACKED ON PALLET (TOP TO TOP, BTM TO BTM)	5	ADDED IVORY (IVO)	RLS	4/26/23	TileWare Products engineering@tilewareproducts.com 1021-16th St SW, Hickory, NC 28602 Office (828) 322-9273 Fax (828) 304-1076	
		PACKAGING FOR RETAIL SALE, PACKED AND TAPED IN SCORED PAD, PART # C910-073						
		MACHINE TO SPECIFICATIONS ABOVE						
<small>Copyright © 2012-2023 TileWare Global, LLC dba TileWare Products®. All rights reserved. PermaTile™ Fastener Patented. US Patent No. 8,161,700 Australian Patent No. 2011205360 Canadian Patent No. 2,787,033. System And Method For Wall Mounting With A Rotating Bushing Patented. US Patent No. 10989353</small>				WEIGHT:		14.725 / 7.423 LB	CUBED: 237.747 / 119.851 IN³	

TOL	MATERIAL	PACK	YES	FINISH	YES	DESCRIPTION	PART #	C501XXX-684	DWG #	810
± SEE BELOW	AVONITE, ACRYLIC SOLID SURFACE, 1/2" [12mm]	SEE NOTES BELOW				CURB, FINISHED TOP ONLY, 6" X 84"	SCALE	1:15	SHEET	3 OF 4

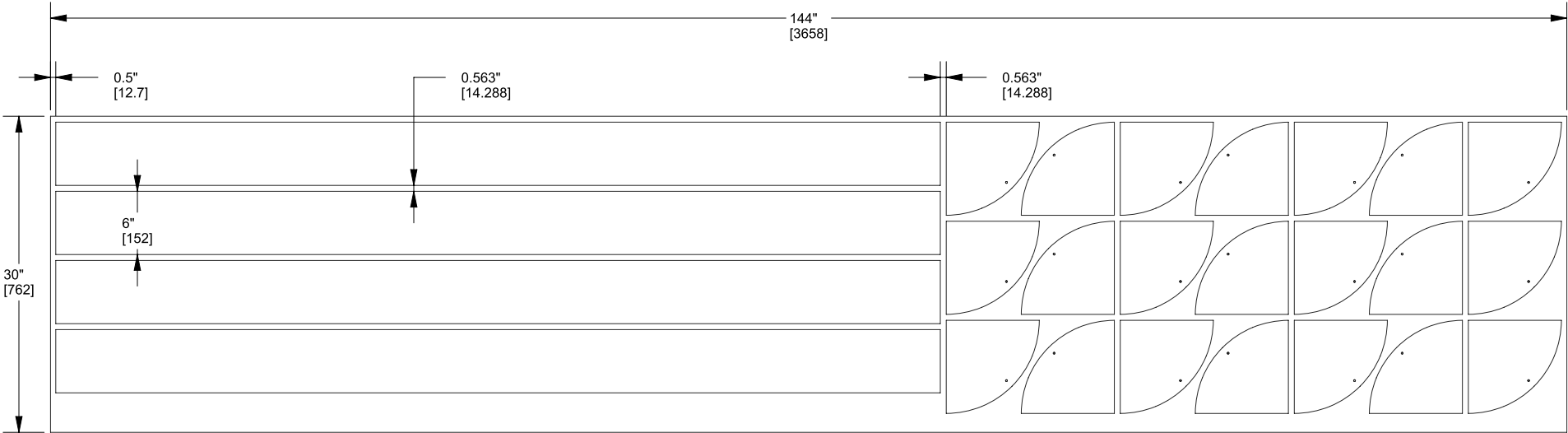

USE 810+706A-LAYOUT.DXF TO PROGRAM FULL SHEET

COLORS
BONE (BON)
DOVE GREY (DVG)
IVORY (IVO)
SUPER WHITE (WHT)

TOOLING / FIXTURE	LOC	MFG. INSTRUCTION / PART INSPECTION	EC #	REVISION	BY	DATE	TW-ENG1	
		NOTES - 810 UNITS PER LB = 0.068, 867 UNITS PER LB = 0.135	1	ADDED 810+867-LAYOUT	RLS	4/26/23	APPROVALS	DATE
		BASED ON SHEET SIZE, THICKNESS = 1/2" [12mm], DIMENSIONS = 30" X 144" [762mm X 3658mm]	2	MADE 810+867-LAYOUT	RLS	4/26/23	DRAWN BY: RLS	1/27/22
		DO NOT TRIM SHEET, DROP TO BE USED TO MACHINE 867		PRIMARY CNC LAYOUT			APPROVED: DHS	4/26/23
		SURFACE FINISHING = 1 SIDED, TOP ONLY	3	ADDED RETAIL PACKAGING	RLS	4/26/23	SHOP:	
		SEE SHEET 4 - COMPONENTS PER FULL SHEET - 810 + 867 = 4X / 4X	4	ADDED BONE (BON)	RLS	4/26/23	REVISION: DHS	4/26/23
		PACKAGING, BULK PACKED ON PALLET (TOP TO TOP, BTM TO BTM)	5	ADDED IVORY (IVO)	RLS	4/26/23	<div>TileWare Products</div> <div>engineering@tilewareproducts.com</div> <div>1021-16th St SW, Hickory, NC 28602</div> <div>Office (828) 322-9273 Fax (828) 304-1076</div>	
		PACKAGING FOR RETAIL SALE, PACKED AND TAPED IN SCORED PAD, PART # C910-073						
		MACHINE TO SPECIFICATIONS ABOVE						
<small>Copyright © 2012-2023 TileWare Global, LLC dba TileWare Products®. All rights reserved. PermaTile™ Fastener Patented. US Patent No. 8,161,700 Australian Patent No. 2011205360 Canadian Patent No. 2,787,033. System And Method For Wall Mounting With A Rotating Bushing Patented. US Patent No. 10989353</small>			WEIGHT:		14.725 / 7.423 LB	CUBED:	237.747 / 119.851 IN³	

TOL	MATERIAL	PACK	YES	FINISH	YES	DESCRIPTION	PART #	C501XXX-684	DWG #	810
±	SEE BELOW	AVONITE, ACRYLIC SOLID SURFACE, 1/2" [12mm]	SEE NOTES BELOW			CURB, FINISHED TOP ONLY, 6" X 84"	SCALE	1:15	SHEET	4 OF 4

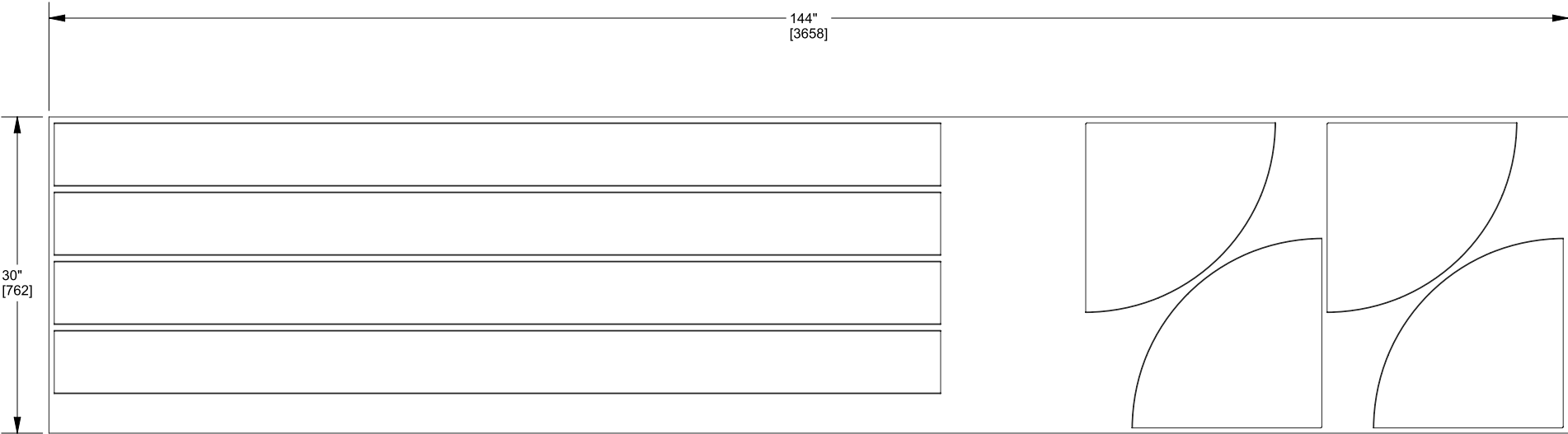

USE 810+867-LAYOUT.DXF TO PROGRAM FULL SHEET

COLORS
BONE (BON)
DOVE GREY (DVG)
IVORY (IVO)
SUPER WHITE (WHT)

TOOLING / FIXTURE	LOC	MFG. INSTRUCTION / PART INSPECTION	EC #	REVISION	BY	DATE	TW-ENG1	
		NOTES - 810 UNITS PER LB = 0.068, 867 UNITS PER LB = 0.135	1	ADDED 810+867-LAYOUT	RLS	4/26/23	APPROVALS	DATE
		BASED ON SHEET SIZE, THICKNESS = 1/2" [12mm], DIMENSIONS = 30" X 144" [762mm X 3658mm]	2	MADE 810+867-LAYOUT	RLS	4/26/23	DRAWN BY: RLS	1/27/22
		DO NOT TRIM SHEET, DROP TO BE USED TO MACHINE 867		PRIMARY CNC LAYOUT			APPROVED: DHS	4/26/23
		SURFACE FINISHING = 1 SIDED, TOP ONLY	3	ADDED RETAIL PACKAGING	RLS	4/26/23	SHOP:	
		SEE SHEET 4 - COMPONENTS PER FULL SHEET - 810 + 867 = 4X / 4X	4	ADDED BONE (BON)	RLS	4/26/23	REVISION: DHS	4/26/23
		PACKAGING, BULK PACKED ON PALLET (TOP TO TOP, BTM TO BTM)	5	ADDED IVORY (IVO)	RLS	4/26/23	<div> <div>TileWare Products</div> <div>engineering@tilewareproducts.com</div> <div>1021-16th St SW, Hickory, NC 28602</div> <div>Office (828) 322-9273 Fax (828) 304-1076</div> </div>	
		PACKAGING FOR RETAIL SALE, PACKED AND TAPED IN SCORED PAD, PART # C910-073						
		MACHINE TO SPECIFICATIONS ABOVE						
<small>Copyright © 2012-2023 TileWare Global, LLC dba TileWare Products®. All rights reserved. PermaTile™ Fastener Patented. US Patent No. 8,161,700 Australian Patent No. 2011205360 Canadian Patent No. 2,787,033. System And Method For Wall Mounting With A Rotating Bushing Patented. US Patent No. 10989353</small>			WEIGHT:		14.725 / 7.423 LB	CUBED:	237.747 / 119.851 IN³	